

MEDIUM PRESSURE (MP)

- Industry standard connection for 20,000 psi applications.

SIZE REFERENCE CHART

SINGLE PIECE MALE • ACTUAL SIZE

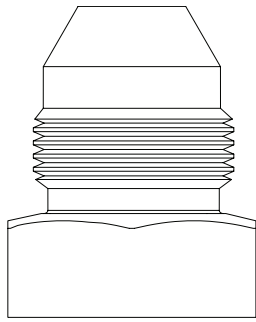

3/4"

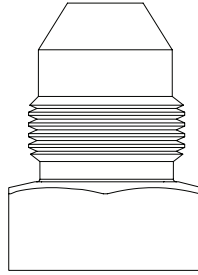

9/16

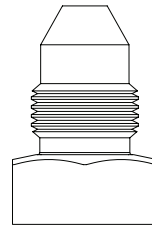

3/8

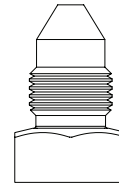

1/4

MEDIUM PRESSURE (MP)

SIZE REFERENCE CHART

GLANDS AND COLLARS • ACTUAL SIZE

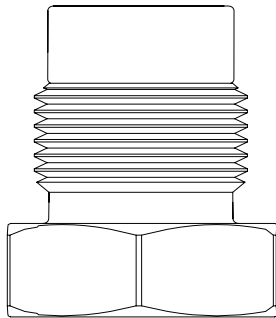

3/4"

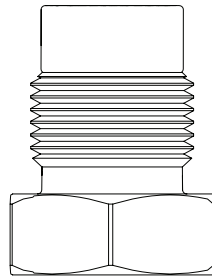

9/16

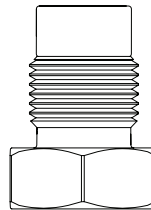

3/8

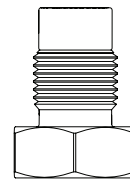

1/4

SIZE	GLAND CONNECTION THREAD	TUBING THREAD LEFT-HAND	RECOMMENDED TORQUE	
			ft-lbs	N-m
1/4 MP	7/16 - 20UNF	1/4 - 28UNF	20	27
3/8 MP	9/16 - 18UNF	3/8 - 24UNF	30	41
9/16 MP	13/16 - 16UNF	9/16 - 18UNF	85	15
3/4 MP	3/4 - 14NPSM	3/4 - 16UNF	90	122
1" MP	1-3/8 - 12UNF	1" - 14UNF	125	170