

# PORTABLE HAND-LANACING TOOL PTL-2000 & PTL-2412 PORTA-LANCE

## OPERATION AND MAINTENANCE MANUAL

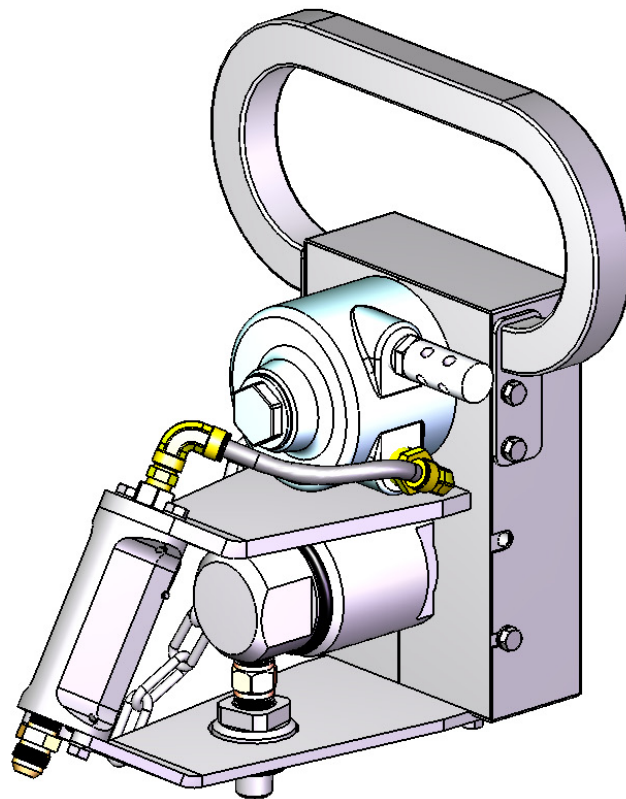

**STONEAGE**®

W A T E R B L A S T T O O L S

466 S. Skylane Drive Durango, Colorado 81303  
www.stoneagetools.com

(970) 259-2869 Phone (970) 259-2868 Fax  
sales@stoneagetools.com

# **TABLE OF CONTENTS**

- 1.0 INTRODUCTION
- 2.0 SAFETY WARNING
- 3.0 DESCRIPTION
- 4.0 PARTS LIST
- 5.0 ASSEMBLY DRAWINGS
- 6.0 MAINTENANCE
- 7.0 WARRANTY

## **APPENDIX**

- A. AIR MOTOR
- B. WATER SWIVEL

## **1.0 INTRODUCTION**

This manual was prepared to provide the operator with the basic information needed to operate and service this equipment. The operating recommendations in the manual will ensure that you receive satisfactory performance. All operating personnel responsible for the care of this equipment should be familiar with the information in this manual.

If you have any questions or problems with this equipment, please contact the distributor you obtained the product from, or the manufacturer:

**StoneAge, Inc.**  
466 S. Skylane Drive  
Durango, CO 81303  
970-259-2869 Phone 970-259-2868 Fax  
[www.stoneagetools.com](http://www.stoneagetools.com)

## **2.0 SAFETY WARNING**

Operations with high pressure water can be potentially dangerous if caution is not exercised. Please read and follow all of these instructions, in addition to the guidelines in the WJTA Recommended Practices handbook.

- 2.1 Only competent and trained persons should operate this equipment.
- 2.2 Do not exceed the maximum operating pressure specified for any component in a system.
- 2.3 This equipment should always be used with an operator controlled dump mechanism to release the high pressure water.
- 2.4 The immediate work area should be marked off to keep out untrained persons.
- 2.5 All personnel in the area should wear eye and hearing protection, as well as other protective clothing in accordance with specific conditions.
- 2.6 Inspect the equipment for visible signs of deterioration, damage, or improper assembly. Do not operate until repaired. Make sure all threaded connections are tight and leak free.
- 2.7 Check to see that all control functions work properly before going to high pressure.
- 2.8 If it is necessary to have a person work near the cleaning jets, then it is this person who should have control of the pressure dump mechanism.
- 2.9 The tool should be securely supported. Strong back thrust is created by waterjets and these forces can become unbalanced if a nozzle should become plugged.

### 3.0 DESCRIPTION

The PTL-2400 & 2412 is an air powered rotary tool for high pressure fluids use. It can apply the power of water jets to drilling or cleaning jobs.

The tool is designed to be used with all common waterblast pumps and compressed air systems. The unit consists of two main components: the air motor and the water swivel. The tool can be used with all standard lance rods and nozzle tips. Special cutting bits with jets are available.

The air motor used in the PTL-2400 & 2412 requires an air supply of 25 to 40 cfm at 80 psi.

### 4.0 PARTS LIST

<u>NUMBER</u>	<u>NAME</u>	<u>SA 2400</u> <u>QTY</u>	<u>SA 2412</u> <u>QTY</u>
AF 063-M12	Adapter, M12-1" Type M	-	1
BJ 354	Open End Link	1	1
BR 155	Muffler	1	1
CB 031	Fitting, Reducer P6P4	1	1
CB 122	Fitting, P6J8	1	1
DB 028	Fitting, 90° P4PL6	1	1
FS 021-K	O-Ring	1	1
GC SP-13-A	Collar, 2 Piece	1	1
GC SP-24-A	Collar, 2 Piece	1	1
GP 055-P8P8	Nipple. P8	1	-
GP 060-P8M	Quick Disconnect, Male	1	-
LM 034.1	Chain	1 FT	1 FT
PTL 010	Handle	1	1
PTL 011	Base Plate	1	1
PTL 012	Bracket, Vertical	1	1
PTL 014	Bracket, Vertical End	1	1
PTL 015	Cover	1	1
PTL 017	Sprocket, Motor 17T	1	1
PTL 018	Belt, 450-5M-25	1	1
PTL 019	Belleville Washer	1	1
PTL 026	Fitting, 90° P8PL6	1	1
PTL 030	Assy, Air Handle	1	1
PTL 025	Handle, Air Valve	1	1
PTL 030.1	Air Valve	1	1
PTL 030.1	Air Valve Plunger	1	1
PTL 030.2	Trigger	1	1
PTL 030.3	Pin	1	1
PTL 030.4	Spring Lock Plunger	1	1
PTL 077	Ring, Retaining	1	1
PTL 033	Eye Bolt	1	1
PTL 072	Sprocket, Swivel 72T	1	1
PTL 078	Ring, Retaining	1	1
SG 051.1	Poly Washer	1	1
SG 051.2	Seal	1	1
SG 055	Air Motor	1	1
SG-M12KL-B-90	Swivel (20K)	-	1
SG-P8KL-B-90	Swivel (15K)	1	-



## **6.0 MAINTENANCE**

This tool has been designed to require a minimum amount of attention by the operator. However, some guidelines should be followed to obtain top performance and a long, useful life.

This tool is capable of fairly high rpm, but it is recommended that a valve be installed in the airline to regulate the top speed. For many applications lower rpm may improve performance. It will definitely be easier on the motor and swivel.

## **7.0 LIMITED WARRANTY**

StoneAge, Inc. warrants to the extent herein provided the products of its own manufacture against defects in material and workmanship under normal use and service for which the products were designed for a period of six months after shipment from the factory. If such products should fail through defect in workmanship or material and specific written notice of failure is made within six months after date of shipment from factory, StoneAge, Inc. will either repair or replace any such items, F.O.B. its factory without charge. StoneAge, Inc. shall not be liable for expense incurred in repairs or alterations made outside the factory without the proper and prior authorization. StoneAge, Inc. shall have the option of requiring the return of the defective products to its factory, with transportation charges prepaid, to establish the claim. StoneAge, Inc. shall in no event be held liable for damages or delay resulting from or arising out of defective products nor for consequential damages or otherwise except for repair or replacement of items of defective material or workmanship aforesaid.

THIS WARRANTY IS EXPRESSLY IN LIEU OF ALL OTHER WARRANTIES EXPRESSED OR IMPLIED INCLUDING THE WARRANTIES OF MERCHANTABILITY AND FITNESS FOR USE AND NEITHER ASSUMES, NOR AUTHORIZES ANY PERSON TO ASSUME FOR STONEAGE, INC. ANY OTHER LIABILITY IN CONNECTION WITH THE SALE OF ITS PRODUCTS. THIS WARRANTY SHALL NOT APPLY TO PRODUCTS OR ANY PARTS THEREOF WHICH HAVE BEEN SUBJECT TO ACCIDENT, NEGLIGENCE, ALTERATION, ABUSE, OR MISUSE. STONEAGE, INC. MAKES NO WARRANTY WHATSOEVER IN RESPECT TO ACCESSORIES, PARTS OR PRODUCTS NOT MANUFACTURED BY STONEAGE, INC.