

Up to 22k psi Power & 80 gpm

Here's how it works

The most impressive feature of the **Torus**® is the simplicity of the design. This tool does not need to be sent to the factory to be repaired. It has very few parts and can be assembled with common hand tools. Easy maintenance means reduced downtime.

There are two primary components inside the **Torus**®, the speed control and the angle block assembly. The magnetic speed control can be replaced easily as a complete unit. The angle block can be removed to replace the High Pressure Seal assemblies.

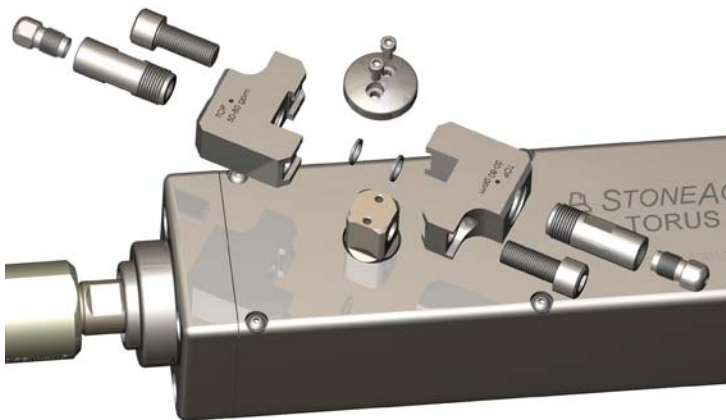

Customer Specifies which Manifold(s)



Manifolds change out quickly in the field.

Interchangeable Manifolds

The three manifolds bolt on and off which allows for quick and easy adaptation to different working pressures and applications. Refer to the chart below to determine the correct manifold and nozzle size.

VESSELS & TANKS

Torus® Jetting Chart

NOZZLE SIZE

		Nozzle Diameter	0.047	0.052	0.057	0.063	0.069	0.075	0.082	0.090	0.098	0.106	0.115	0.125	0.135	0.145	0.155	0.165	
		Nozzle Number	4	5	5.5	6.5	8	10	12	14	16	19	23	27	31	36	41	46	
PRESSURE, PSI	2,000	FLOW, GPM	<i>Torus</i> ® at 2k psi must use fast rotation										26	30	34	39	43	47	51
		MANIFOLD											LF	LF	LF	LF	LF	LF	LF
	5,000	FLOW, GPM					18	22	26	30	35	41	47	54	61	68	75		
		MANIFOLD					LF	LF	LF	LF	MF	MF	MF	MF	HF	HF	HF		
	10,000	FLOW, GPM			17	22	26	30	36	42	50	57	66	76					
		MANIFOLD			LF	LF	LF	LF	MF	MF	MF	MF	MF	HF	HF				
	15,000	FLOW, GPM		18	21	27	31	37	44	52	61	70	81						
		MANIFOLD		LF	LF	LF	MF	MF	MF	HF	HF	HF	HF						
	22,000	FLOW, GPM	17	20	24	30	36	42	51	60	70	81							
		MANIFOLD	LF	LF	LF	MF	MF	MF	HF	HF	HF	HF							