

High Flow Carbide Inserts

The Best Way to Handle Your High Flow Applications

We recommend using our **OC8 Holders** and **OC8 Carbide Inserts** where filtration is poor, abrasive solids are present, or for very high flow applications. These nozzle tips are offered for both 15K psi and 20K psi connections. The replaceable carbide inserts are available in large orifice diameters to handle high flows and offer a long taper to provide excellent jet quality and distance. Additional **OC8 Flow Conditioners** are available by request.



OC8-P8

The **OC8-P8 Holder** and **OC Carbide Inserts** for 15K psi, 1/2" npt, female connection.



OC8-P12

The **OC8-P12 Holder** and **OC Carbide Inserts** for 15K psi, 3/4" npt, female connection.



OC8-G12

The **OC8-G12 Holder** and **OC Carbide Inserts** for 20Kpsi, 3/4" G12, female connection.

OC8 Flow Conditioners can be used with each of the holders above. These devices reduce turbulence in the water which helps provide better jet quality and increase production with harder hitting jet power. Recommended for extensions 6" and shorter.

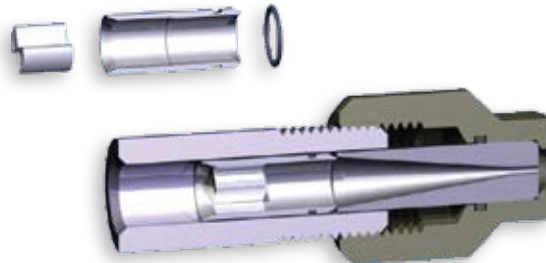

OC8 Flow Conditioner Assembly

OC8 Carbide Insert Flow Chart (in gpm)

ORIFICE ID		Pressure - kpsi & bar										Flow Rating
		2	4	6	8	10	12	14	16	18	20	
in.	mm	138	276	414	552	700	827	966	1103	1241	1400	
.063	1.6	4.8	6.7	8.2	9.5	10.6	11.7	12.6	13.5	14.3	15.11	6
.075	1.9	6.8	9.6	11.7	13.5	15.1	16.6	17.9	19.1	20.3	21.4	9
.085	2.1	8.7	12.3	15	17.4	19.4	21.3	23	24.6	26	27.5	12
.095	2.4	10.8	15.3	18.8	21.7	24.3	26.6	28.7	30.7	32.6	34.3	15
.105	2.7	13.2	18.8	23	26.5	29.7	32.5	35.1	37.5	39.8	42	19
.125	3.2	18.8	26.6	32.5	37.6	42	46	49.7	53.2	56.4	59.4	26
.145	3.7	25.3	35.8	43.8	50.6	56.6	62	67	71.6	75.9	80	36
.165	4.2	32.7	46.3	56.7	65.5	73.2	80.2					46
.190	4.8	43.4	61.4	75.2	86.9	97.1	106					61
.215	5.5	55.6	78.7	96.3	111	124						78
.250	6.3	75.2	106	130	150	168						106