

# BRLM 180 AND BRLM 180-H DUAL GEARBOX ASSEMBLY

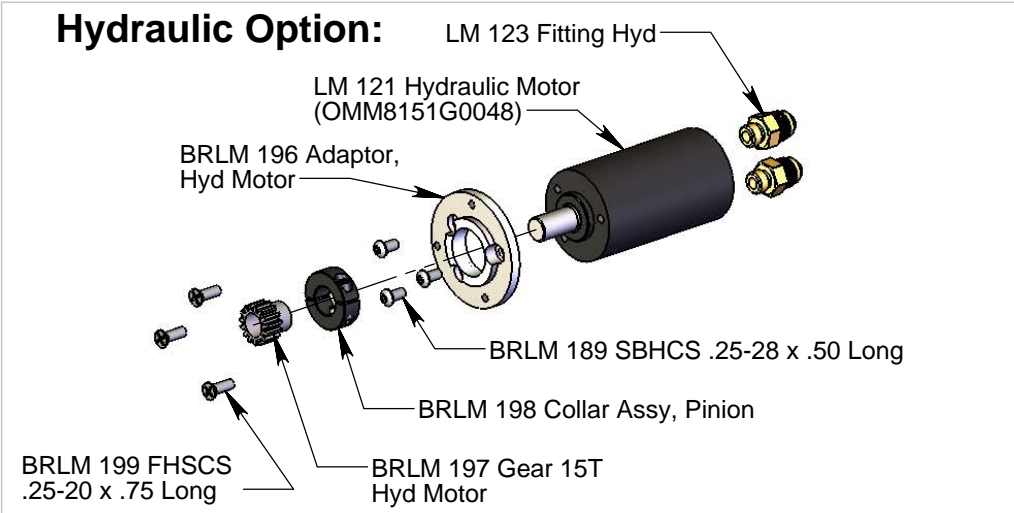
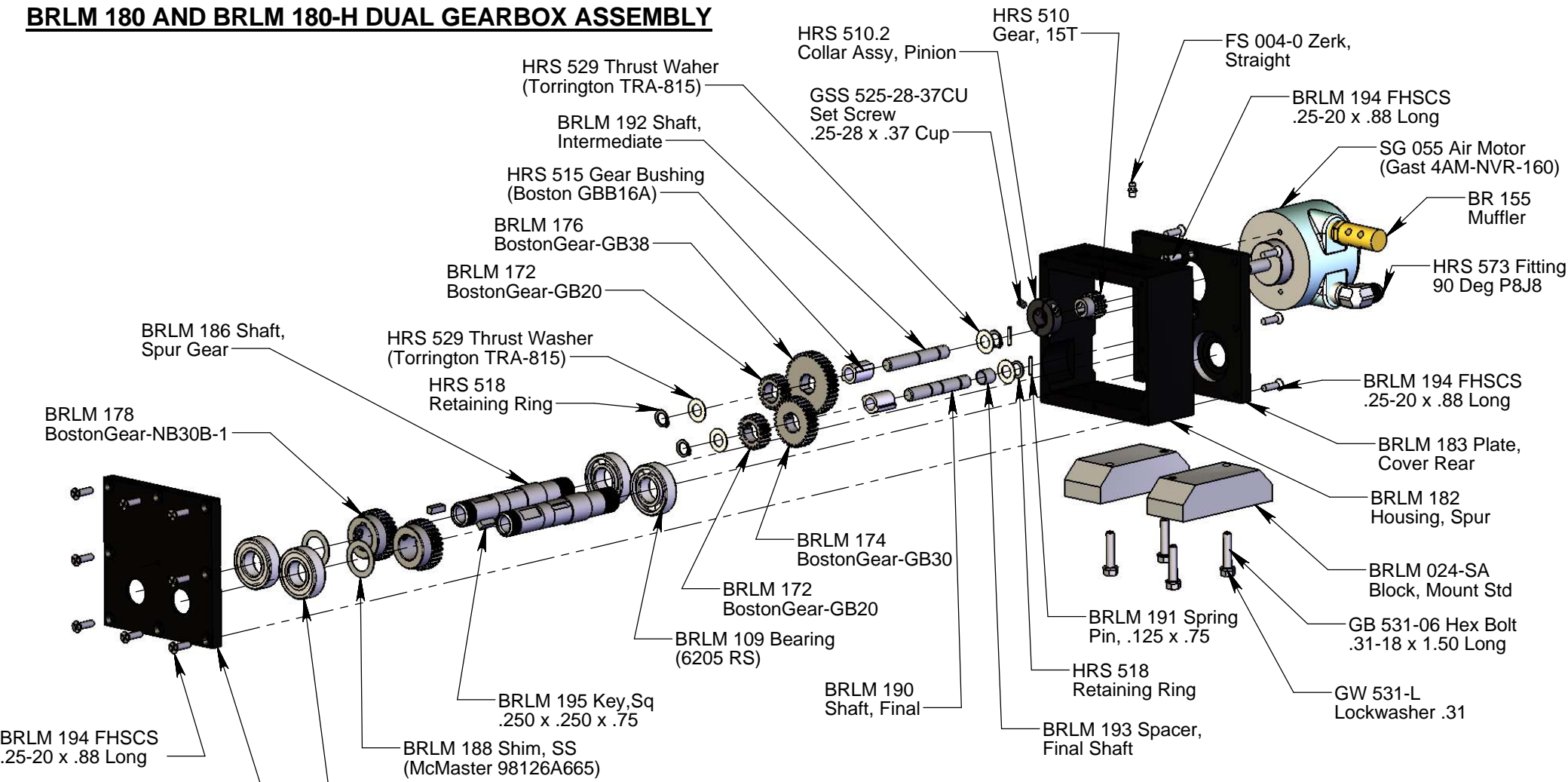

**Note:** This gearbox is factory filled with Texaco Marfak Multipurpose 2 Grease. It is normal for the gearbox to leak small amounts of oil that has separated from the lithium thickener. This slight loss of oil will not affect the lubricating properties of the grease or the performance of the gearbox. It is recommended to grease the gearbox every 10-12 hours. Any multipurpose NLGI 2 grease is acceptable.